

Fitting Instructions

Revo Open Cone Intake Kit MQB EVO 2.0TSI Low Output

Fitting Difficulty



Contents

Description	
Revo Air Filter	1
Revo Air Filter Hard Pipe	1
Revo Heatshield	1
Revo Heatshield Bracket	1
Revo Intake Hose	1
Revo Hose Bracket	1
Revo Turbocharger Inlet	1
Turbocharger Inlet O-Ring	1
Airbox Grommets	3
Hose Clamp Bracket Assembly	1
M6 x 1.0 x 20mm Stainless Steel Cap Head Bolt	3
M6 x 1.0 x 20mm Stainless Steel Countersunk Bolt	1
M6 x 1.0 Stainless Steel Nylon Lock Nut	2
M6 Stainless Steel Flat Washer	5
90-110mm Stainless Steel Worm Drive Hose Clamp	2
70-90mm Stainless Steel Worm Drive Hose Clamp	1

Recommended Tools

Tools	Size
Ratchet	
Sockets	7, 10, 13mm
Torx Bits	T30
Hex Bits	5mm
Tension Clamp Pliers	



Before starting, please ensure that the engine is cool and the battery is disconnected. Engine temperatures can remain high for a substantial amount of time after use.



Fitting Instructions

Fitting Difficulty



Revo Open Cone Intake Kit MQB EVO 2.0TSI Low Output

⚠ Installation was performed on a UK-spec. Mk8 Golf GTI. Installation on other vehicles will be similar but may not be exact.

- 1 Open the bonnet, remove the engine cover by pulling it straight up to disengage the cover grommets and loosen the rear intake hose clamp using a 7mm socket. Loosen the airbox lid hose clamp using constant tension clamp pliers and remove the intake hose

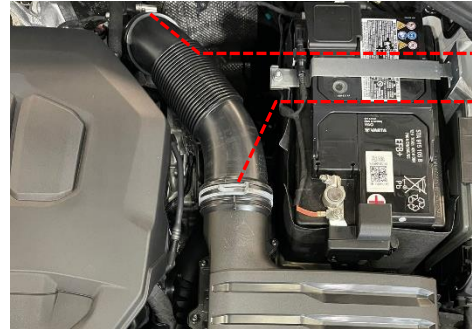

- 2 Remove the bolt affixing the turbocharger inlet pipe to the turbocharger with a T30 Torx bit. Twist the inlet pipe toward the firewall and remove it from the turbocharger

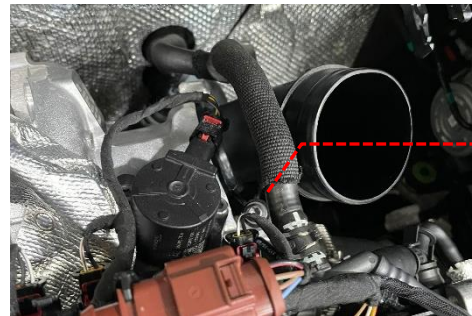

- 3 Install the supplied o-ring onto the groove on Revo turbocharger inlet (if not already installed) and lightly oil the o-ring with engine oil. Install the Revo inlet into the turbocharger and secure it to the turbocharger using the included M6 countersunk bolt and a T30 Torx bit. Torque the bolt to 9 ft.-lbs. (12Nm)



- 4 Loosely install the Revo intake hose onto the Revo turbocharger inlet with the supplied 70-90mm hose clamp and a 7mm socket. Do not tighten the clamp at this time

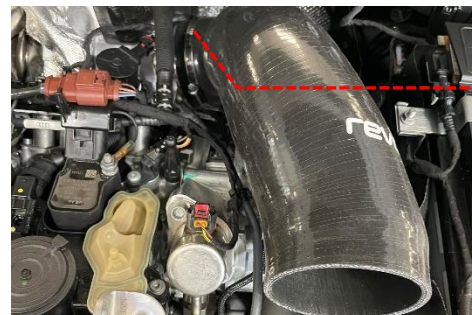

Fitting Instructions

Revo Open Cone Intake Kit MQB EVO 2.0TSI Low Output

Fitting Difficulty



- 5 Disconnect the vacuum line from the airbox lid and remove the airbox assembly from the vehicle by pulling it straight up, to unseat the airbox grommets from the chassis mounts

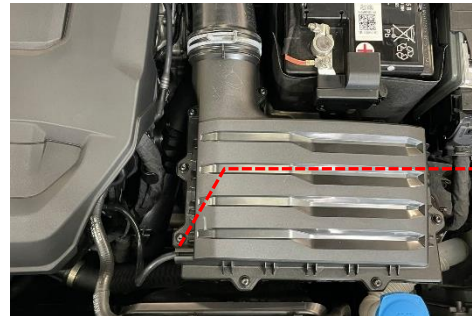

- 6 Assemble the supplied hose clamp bracket, Revo hose bracket and (1) of the included 90-110mm hose clamps as shown. Do not tighten the M8 nylon lock nut at this time

Note: Be sure the Revo pipe bracket is oriented as shown



- 7 Remove the bolt shown from the engine head with a T30 Torx bit

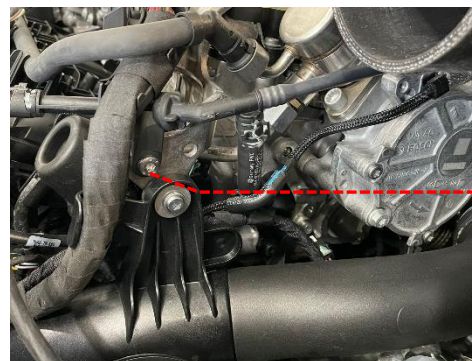

- 8 Using one of the supplied M6 x 20mm cap head bolts and M6 washers, as well as a 5mm hex bit, install the Revo bracket assembly into the engine bay as shown. Torque the bolt to 9 ft.-lbs. (12Nm)

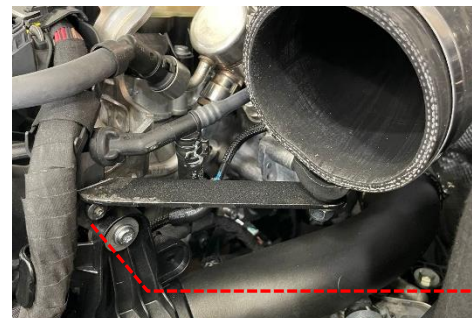

Fitting Instructions

Revo Open Cone Intake Kit MQB EVO 2.0TSI Low Output

Fitting Difficulty



- 9 Install (2) of the supplied airbox grommets into the Revo heatshield and the remaining grommet into the Revo heatshield bracket. Install the Revo heatshield bracket onto the Revo heatshield as shown, using the remaining M6 bolts, washers and lock nuts supplied as well as a 5mm hex bit and 10mm socket. Tighten the M6 bolts/nuts fully

Note: Be sure the Revo heatshield bracket is oriented as shown, the bolts are installed in the direction shown and the supplied grommets are installed in the orientations shown

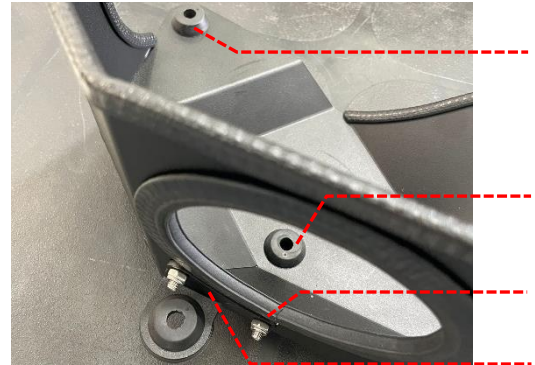

- 10 Install the Revo heatshield into the vehicle by pressing it onto the (3) chassis mounts as shown



- 11 Install the Revo filter hard pipe into the Revo intake hose and tighten the 90-110mm hose clamp from the Revo pipe bracket with a 7mm socket, to loosely hold the Revo hard pipe in place. Do not fully tight the hose clamp at this time

- 12 Using the remaining 90-110mm hose clamp supplied and an 7mm socket, install the Revo air filter onto the Revo hard pipe. Position the Revo intake hose, hard pipe and air filter as shown and tighten all (3) hose clamps with an 7mm socket

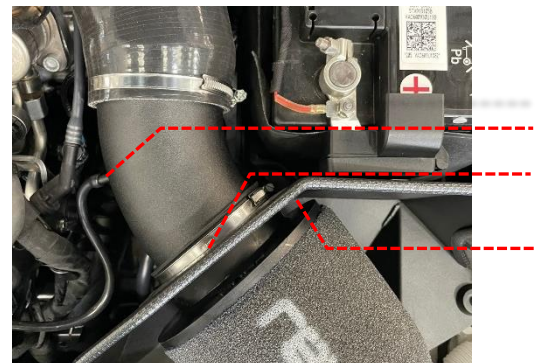

Fitting Instructions

Revo Open Cone Intake Kit MQB EVO 2.0TSI Low Output

Fitting Difficulty



- 13 Tighten the M8 nylon lock nut on the bottom Revo pipe bracket assembly, using a 13mm socket. Connect the vacuum line to the Revo hard pipe. Check all bolts/clamps are fully tightened and reinstall the engine cover.

Test drive the vehicle to ensure vehicle performs correctly and there are no leaks/part interference during operation. Your installation is now complete!

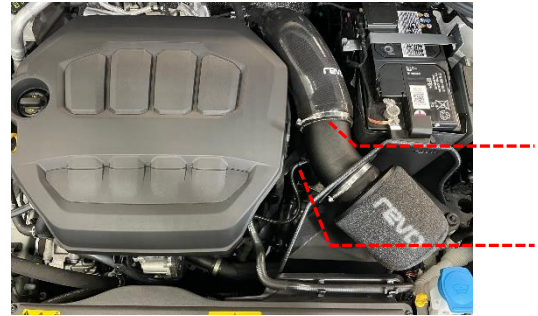

Fitting Instructions

Revo Open Cone Intake Kit MQB EVO 2.0TSI Low Output

Fitting Difficulty

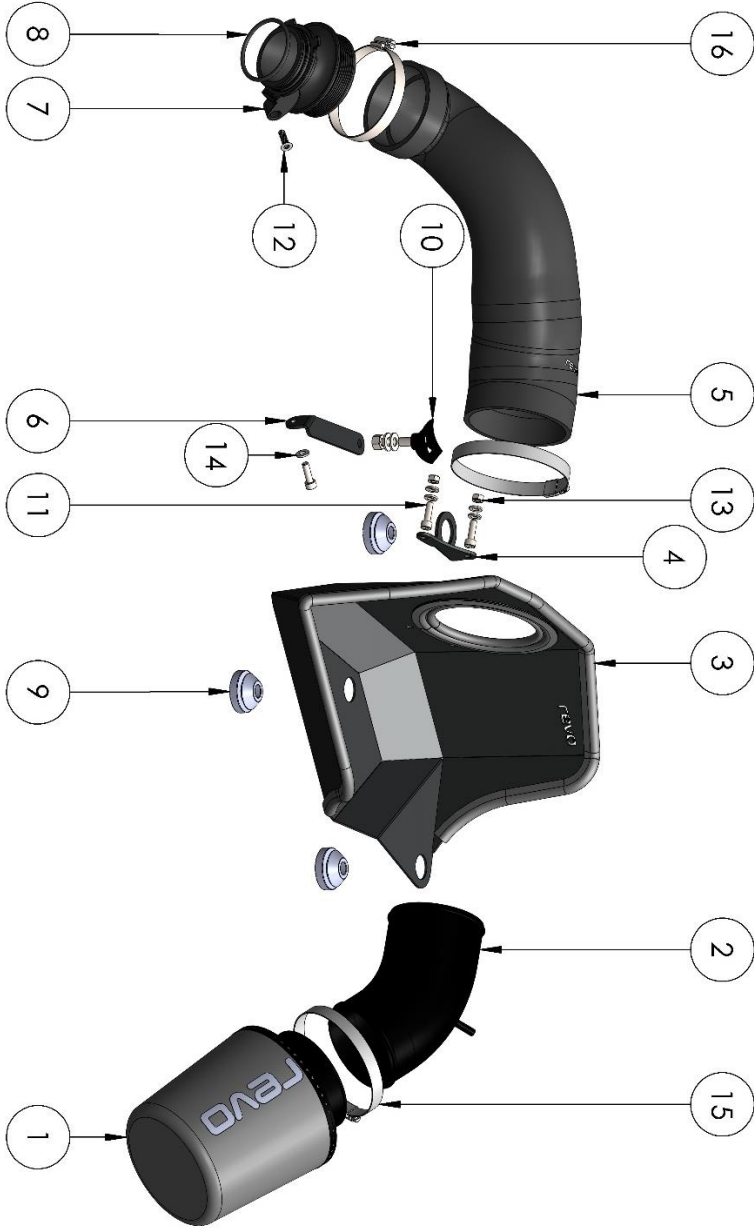

ITEM NO.	DESCRIPTION	QTY.
1	REVO AIR FILTER	1
2	REVO AIR FILTER HARD PIPE	1
3	REVO HEATSHIELD	1
4	REVO HEATSHIELD BRACKET	1
5	REVO INTAKE HOSE	1
6	REVO HOSE BRACKET	1
7	REVO TURBOCHARGER INLET	1
8	TURBOCHARGER INLET O-RING	1
9	AIRBOX GROMMET	3
10	HOSE CLAMP BRACKET ASSEMBLY	1
11	M6 x 1.0 x 20MM STAINLESS STEEL CAP HEAD BOLT	3
12	M6 x 1.0 x 20MM STAINLESS STEEL COUNTERSUNK BOLT	1
13	M6 x 1.0 STAINLESS STEEL NYLON LOCK NUT	2
14	M6 STAINLESS STEEL FLAT WASHER	5
15	90-110 MM STAINLESS STEEL WORM DRIVE HOSE CLAMP	2
16	70-90MM STAINLESS STEEL WORM DRIVE HOSE CLAMP	1